



Tri-County Regional Vocational Technical School Building Project



Tri-County Regional

Vocational Technical High School

Franklin, Massachusetts



Serving the communities of:
Franklin, Medfield, Medway, Millis, Norfolk, North
Attleboro, Plainville, Seekonk, Sherborn, Walpole
& Wrentham

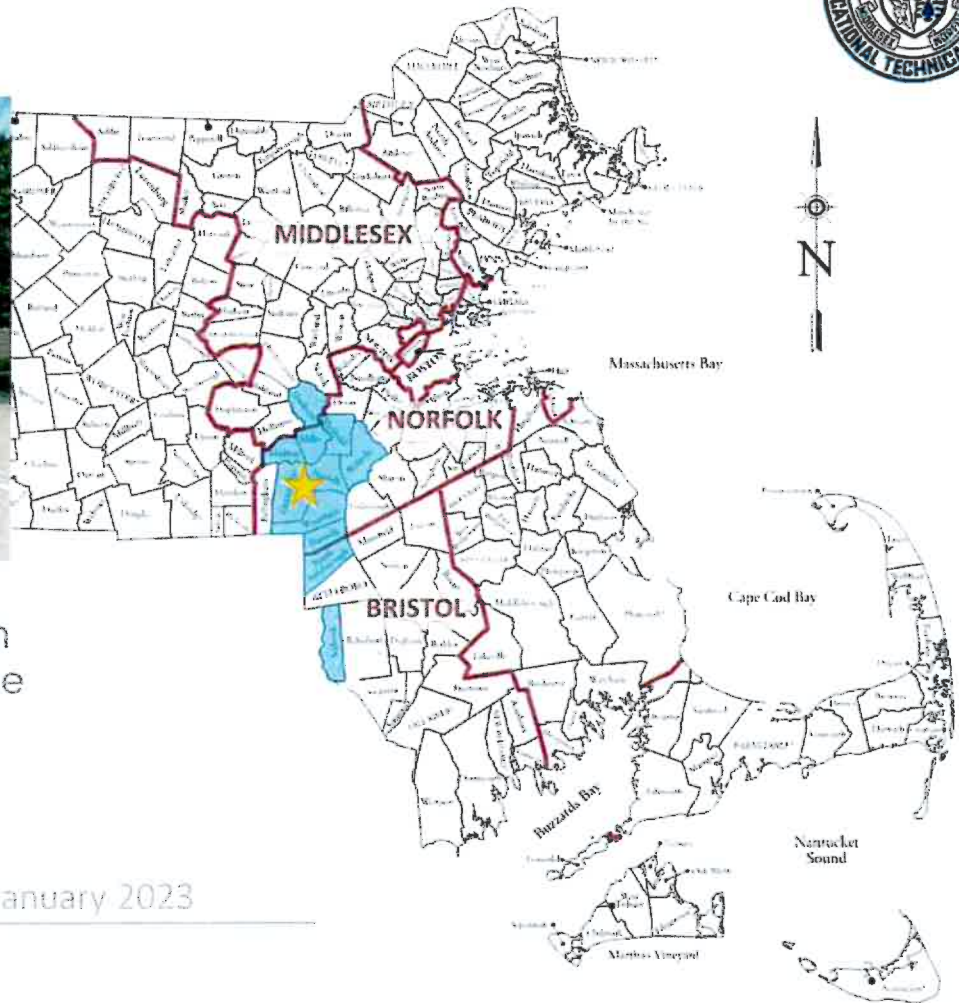

MSBA | Facilities Assessment Subcommittee

January 2023



Administering a Transparent Process

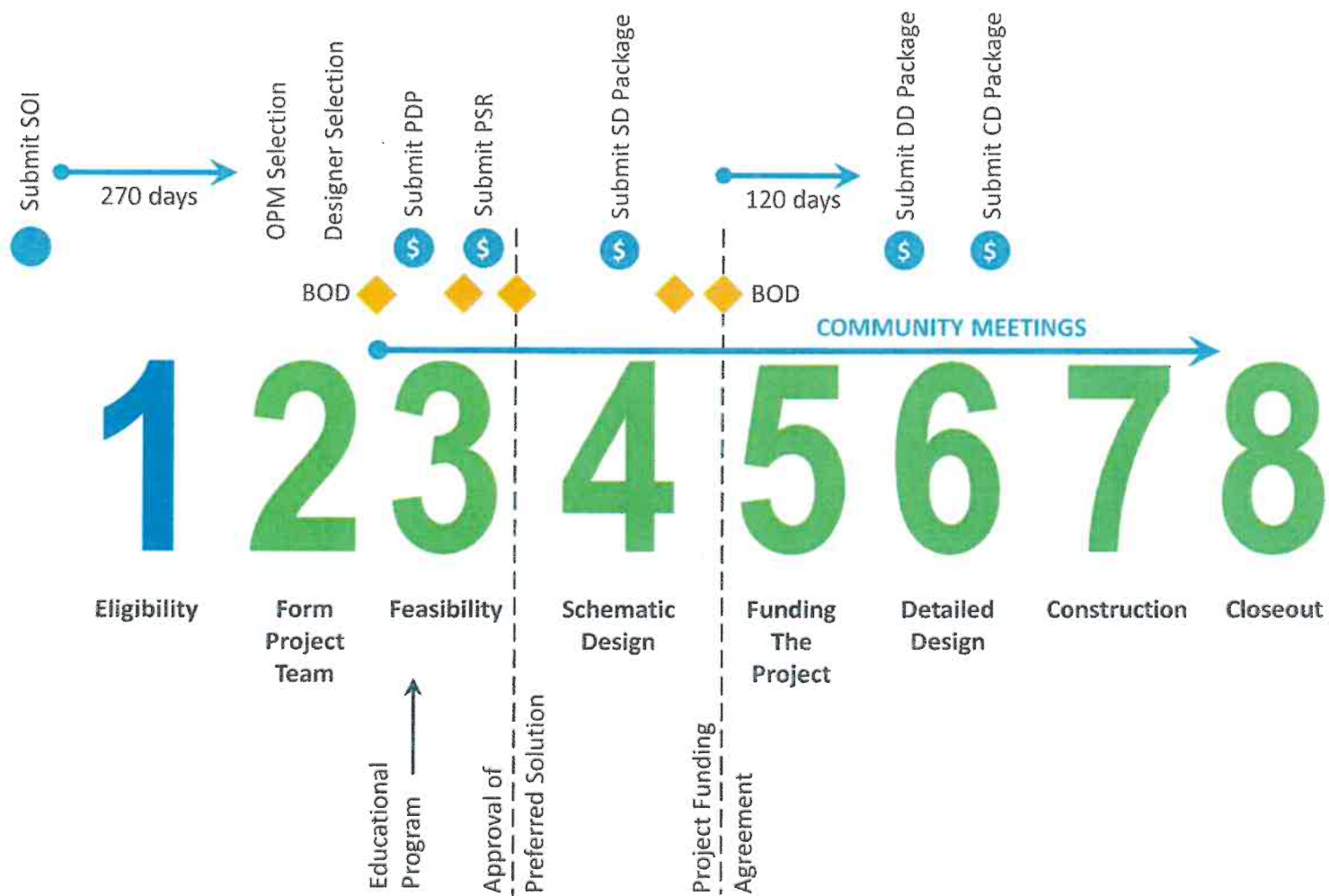

3

SEPT
2021

FEASIBILITY STUDY

PLANNING

Public Visioning Sessions

Existing Conditions Review

Develop Full Range of Options

Prelim. Evaluation of
Alternatives

Submit PDP August 5th

Select Preferred Option

Submit PSR Dec 28th

4

MAR
2023

SCHEMATIC DESIGN

SEPTEMBER
2023

DESIGN

Initiate Schematic Design

Develop Cost Estimates

Submit to MSBA for Approval

Public Presentations
Preferred Option & Cost

Regional
Community Votes
Fall 2023

Project Timeline

Tri-county RTVHS

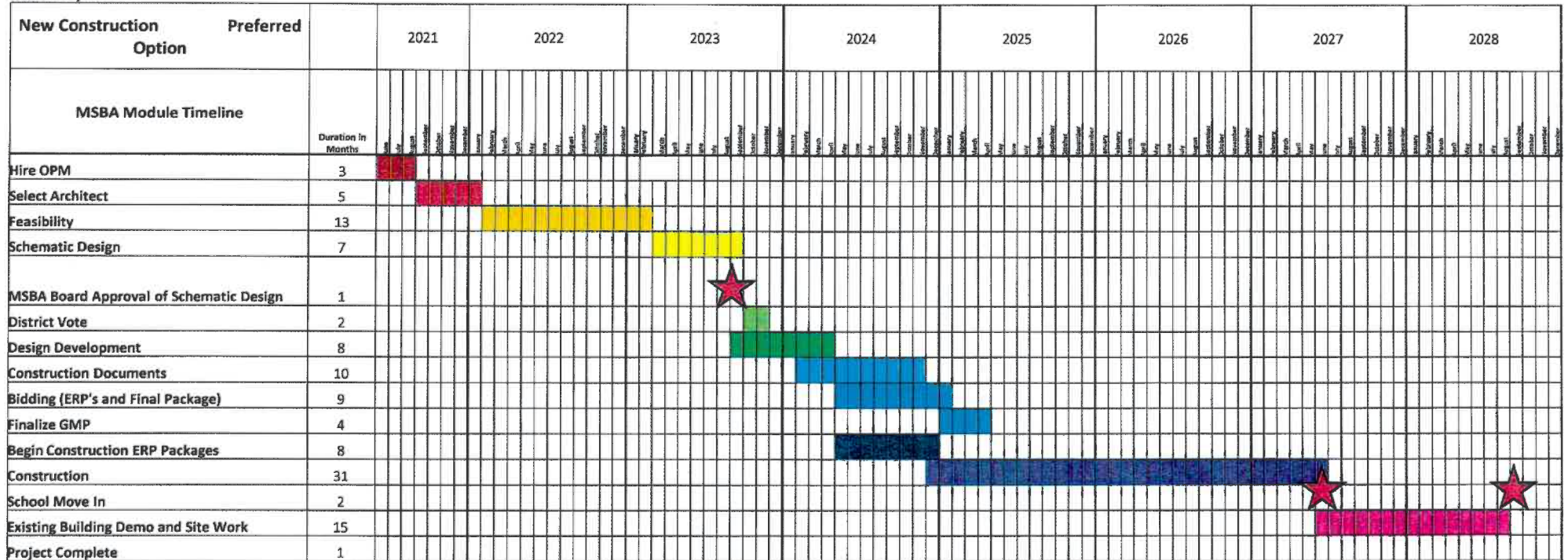

The MSBA process to determine the best design for Tri-County

- ✓ Develop and evaluate multiple building concepts
- ✓ Reduce the number of concepts down to 3 for further study
PDP Submission **August 5th 2022**
- ✓ Select 1 that best meets the needs of the community for the next 50 years
PSR Submission **December 28th 2022**
- ✓ Meet with architects and develop schematic design for preferred option
PSD Meeting with MSBA **June 2023**

Preliminary Pricing Table

Option (Description)	Total Gross Square Feet	Square Feet of Renovated Space (\$*/SF)	Square Feet of New Construction (\$*/SF)	Site, Building Takedown, Haz Mat Etc. (\$*)	Estimated Total Construction** (\$*)	Estimated Total Project Costs (\$)
Base Building Repair Option	285,000 sf	285,000 sf	- sf	\$ 29,707,000	\$ 123,757,000	\$ 165,000,000
		\$ 330.00 \$/sf	\$ - \$/sf		\$ 434.24 \$/sf	
Addition-Renovation Option 3.1.1	313,000 sf	269,571 sf	43,429 sf	\$ 21,827,146	\$ 220,591,817	\$ 279,796,239
		\$ 611.65 \$/sf	\$ 780.16 \$/sf		\$ 704.77 \$/sf	
Addition-Renovation Option 4	320,000 sf	233,972 sf	86,028 sf	\$ 23,723,192	\$ 229,932,020	\$ 282,528,009
		\$ 593.06 \$/sf	\$ 784.04 \$/sf		\$ 718.54 \$/sf	
New Construction Option 3	285,500 sf		285,500 sf	\$ 37,198,982	\$ 231,818,582	\$ 279,898,689
			\$ 681.68 \$/sf		\$ 811.97 \$/sf	

* Marked Up Construction Costs

** Does not include Construction Contingency

*** District's Preferred Solution





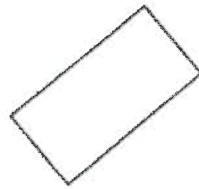

Department Legend

- 1.0 Core Academic
- 2.0 Special Education
- 3.0 Art & Music
- 4.0 Vocations & Technology
- 5.0 Health & Physical Education
- 6.0 Media Center
- 7.0 Auditorium / Drama
- 8.0 Dining & Food Service
- 9.0 Medical
- 10.0 Administration & Guidance
- 11.0 Custodial & Maintenance
- 12.0 Other
- 13.0 Non-Programmed Spaces
- 13.2 Toilets
- Post-Graduate & Adult Education

1 Space Summary New Level 1
1" = 50'-0"

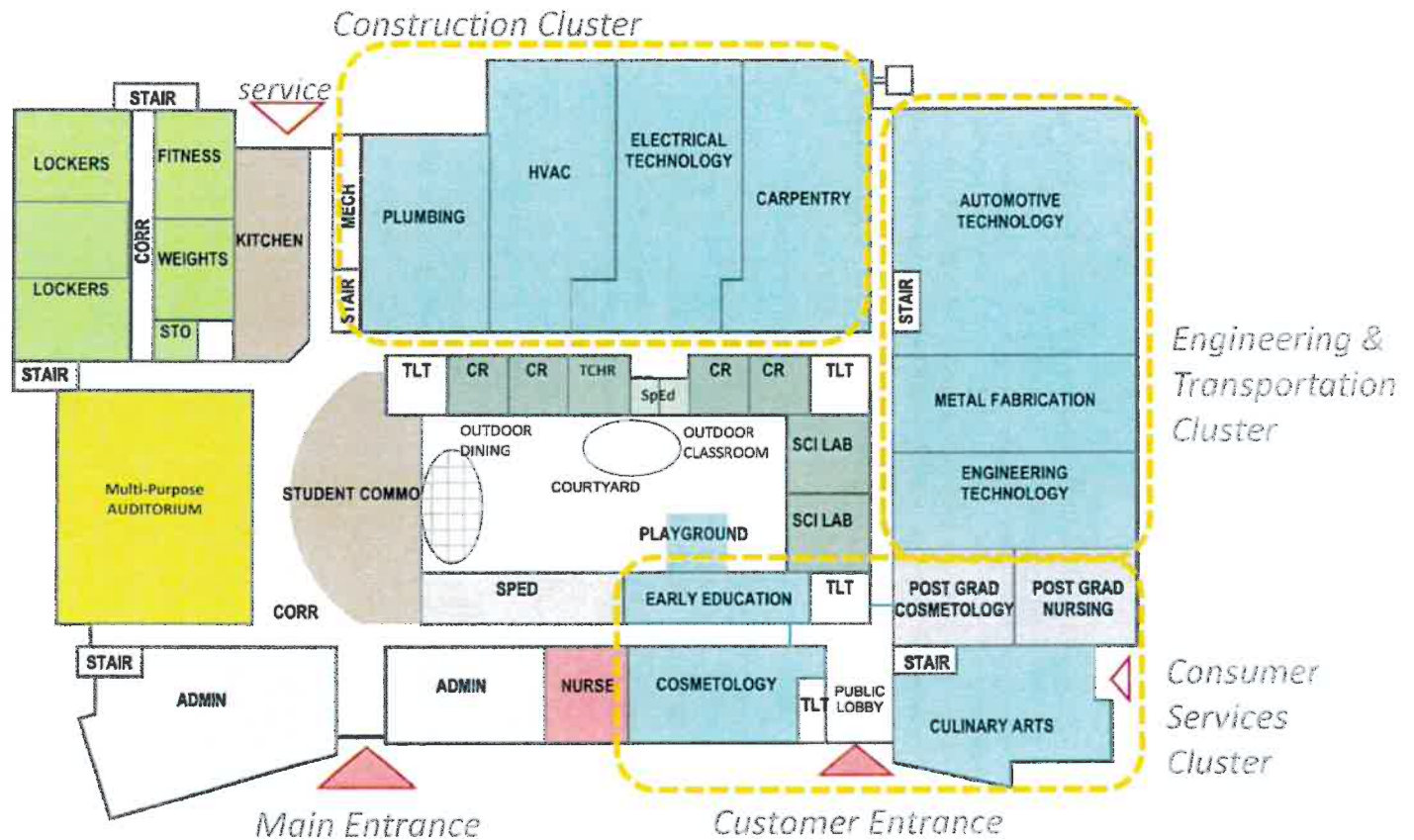

Preferred Option First Floor Plan



Department Legend

- 1.0 Core Academic
- 2.0 Special Education
- 3.0 Art & Music
- 4.0 Vocations & Technology
- 5.0 Health & Physical Education
- 6.0 Media Center
- 7.0 Auditorium / Drama
- 8.0 Dining & Food Service
- 9.0 Medical
- 10.0 Administration & Guidance
- 11.0 Custodial & Maintenance
- 12.0 Other
- 13.0 Non-Programmed Spaces
- 13.2 Toilets

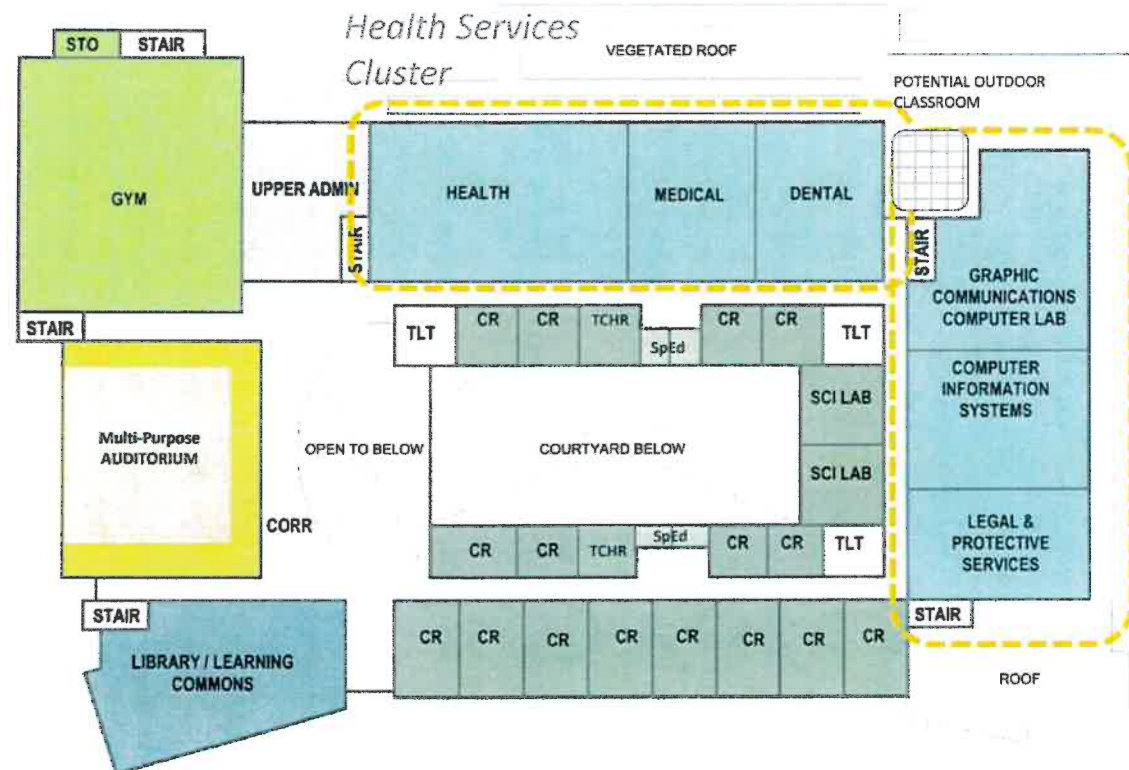

1. Space Summary New Level 2
1" = 50'-0"

Preferred Option Second Floor Plan

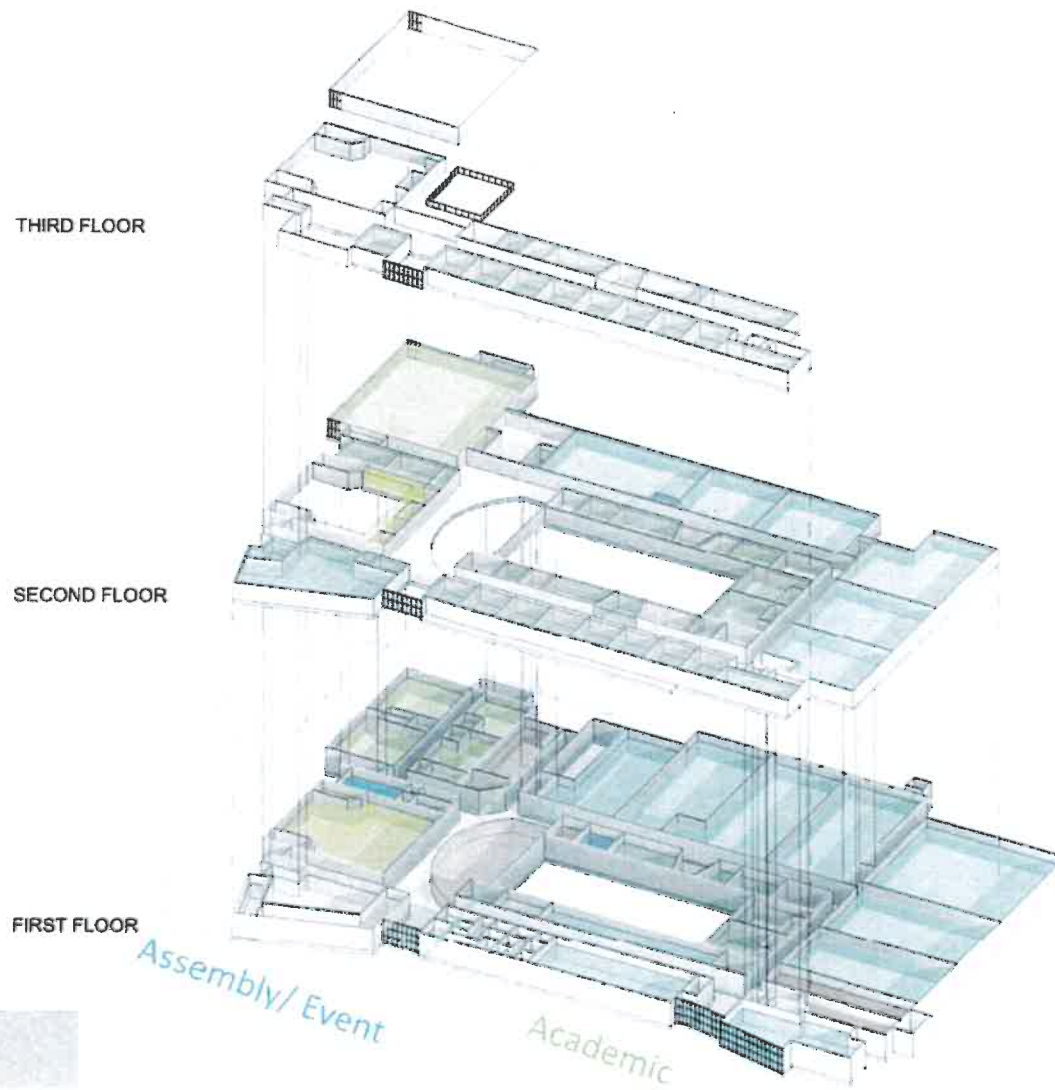

Stacking Diagram

Important Dates

- Community Presentation #4 – May-June, 2023
- 2nd Town Clerk's Information Breakfast – April-May, 2023
- Joint School Committee and School Building Committee Meetings- Spring 2023
- Preliminary Schematic Design Report to MSBA for Board Approval – June 2023
- Regional Community-wide vote to fund the project –Oct 2023

District Vote Process

- District Ballot Election – Chapter 71 Section 16(n) (October 2023)
- Debt Issue – 30 year bond
- Debt repayment assessment based on October 1 enrollment annually
- Assumed 5 pupil minimum for capital debt assessment

Tri-County Enrollment by town for October 2022 (Preliminary) with comparative October 2021 (Final)

					FY 24 Budget Calculation	FY 23 Budget Calculation	
TOWN	9	10	11	12	GRAND TOTAL	GRAND TOTAL	Change
Franklin	43	39	39	43	164	157	7
Medfield	--	1	1	4	6	8	-2
Medway	35	16	18	16	85	64	21
Millis	5	12	2	19	38	51	-13
Norfolk	14	15	6	6	41	33	8
North Attleborough	62	60	66	49	237	256	-19
Plainville	38	24	21	30	113	91	22
Seekonk	25	16	21	23	85	82	3
Sherborn	1	--	--	--	1	0	1
Walpole	29	15	28	18	90	84	6
Wrentham	21	23	12	17	73	69	4
TOTAL IN DISTRICT	273	221	214	225	933	895	38